



MAYTREE CLOSE

EDGWARE, HA8 8XX

£520,000
FREEHOLD

Situated on the peaceful cul-de-sac of Maytree Close, just a short walk from the amenities of Glengall Road and within the Eruv, this well-presented three-bedroom end-of-terrace home is perfect for families looking to move up or down the property ladder. The property features a kosher kitchen, a practical utility cupboard, and a recently modernised family bathroom. With its quiet location and functional layout, this is a rare opportunity to secure a comfortable and well-located family home.



TAYLOR HAWKINS
Estate Agents
0208 958 2222 / TaylorHawkins.co.uk

Total Floor Area
44.63m²

Total Floor Area
44.01m²

Ground Floor

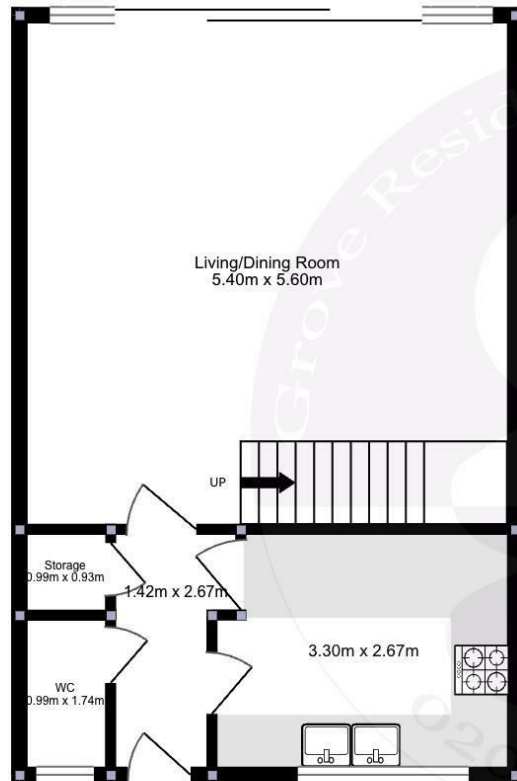

1st Floor

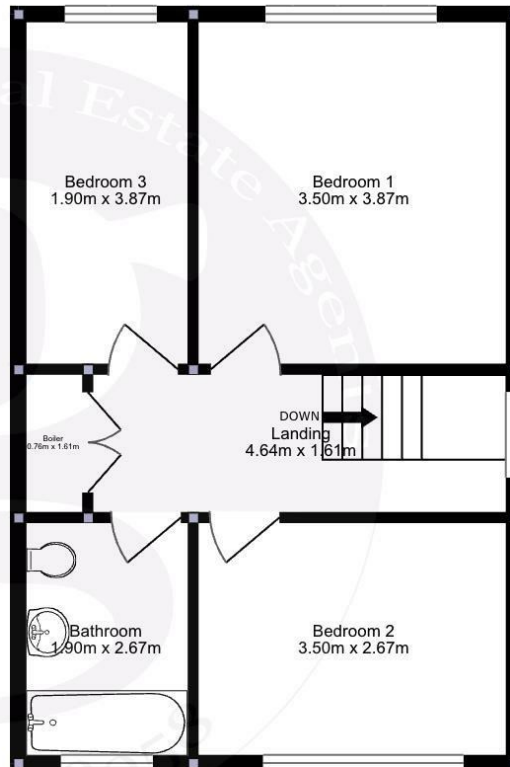

This floorplan has been prepared with all due care and attention, by Grove Residential for the convenience of intending buyers/tenants. Its accuracy is not guaranteed and it does not form any part of a contract. Purchasers/tenants should check by inspection its accuracy prior to signing a contract.

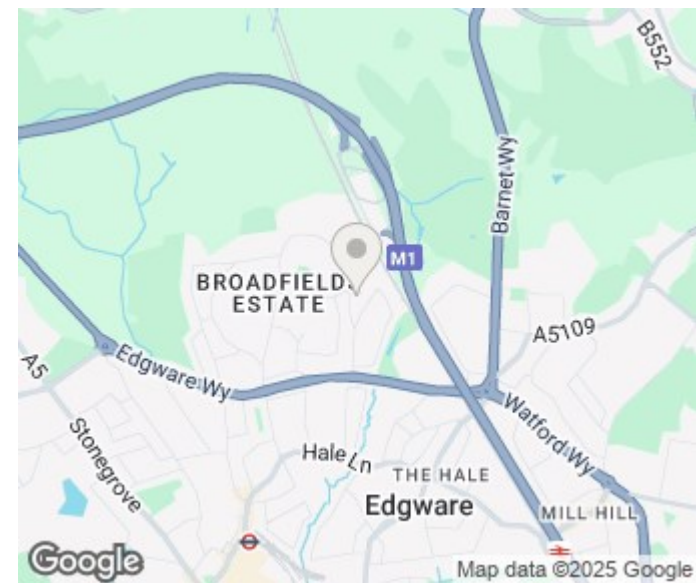

Energy Efficiency Rating		
	Current	Potential
Very energy efficient - lower running costs		
(92 plus) A		86
(81-91) B		
(69-80) C		62
(55-68) D		
(39-54) E		
(21-38) F		
(1-20) G		
Not energy efficient - higher running costs		
England & Wales		EU Directive 2002/91/EC

Agents Note: Whilst every care has been taken to prepare these particulars, they are for guidance purposes only. All measurements are approximate and are for general guidance purposes only and whilst every care has been taken to ensure their accuracy, they should not be relied upon and potential buyers/tenants are advised to recheck the measurements

Edgware Sales
58 Edgware Way
Edgware
Middlesex
HA8 8DJ

020 8958 2222
property@taylorhawkins.co.uk
<https://taylorhawkins.co.uk/>



TAYLOR HAWKINS
Estate Agents
0208 958 2222 / TaylorHawkins.co.uk